

STUDIO DUFFY

Architecture + Interiors

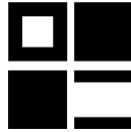

CONTENTS /



ABOUT US / 5

Our Services
Hospitality Specialists

HOTELS / 9

Bunratty Castle Hotel
Iveagh Garden Hotel
Sheen Falls Lodge
Sandymount Hotel
Castlemartyr Resort Hotel
Trinity Townhouse
Tulfarris Manor House
Radisson Blu

BARS & RESTAURANTS / 29

Gallery Bar, Le Pole Square
Allta Restaurant
Bar Italia
Terenure Inn
Bracken Court Hotel

ABOUT US

With over 30 years of experience, our team offers a comprehensive suite of services. Our multidisciplinary approach ensures that each project is handled with precision, creativity and adherence to the highest industry standards.

Our commitment to creativity, compliance and seamless project delivery enables us to bring our clients' visions to life, no matter the scale or complexity.

SERVICES

- Architecture
- Interiors
- Feasibility Studies
- Planning Application Management
- Project Management
- Disability Access Certificates (DAC)
- Fire Safety
- Design Certifier
- Assigned Certifier
- Opinion on Compliance
- Domestic BER



HOSPITALITY SPECIALISTS

Over the years, we've built strong relationships with trusted partners and clients. Their collaboration and trust in our expertise have enabled us to deliver exceptional results across projects, from industrial spaces to high-end hospitality designs.



RADISSON BLU
DUBLIN 8



BUNRATTY CASTLE HOTEL
CO. CLARE



IVEAGH GARDEN HOTEL
DUBLIN 2



CLIFDEN STATION HOUSE HOTEL
CO. GALWAY



TULFARRIS HOTEL
CO. WICKLOW



TRINITY TOWNHOUSE
DUBLIN 4



SHEEN FALLS LODGE
CO. KERRY



BRACKEN COURT HOTEL
CO. DUBLIN



SANDYMOUNT HOTEL
DUBLIN 4



CASTLEMARTYR RESORT
CO. CORK

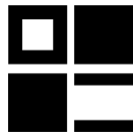

HOTELS /

With an aim to create innovative hotel designs that seamlessly blend comfort, style, and functionality, our focus is on designing spaces that foster memorable guest experiences while reflecting the unique essence of each property.

From luxurious interiors to thoughtful layouts, we work closely with hotel owners and operators to ensure every design enhances operational efficiency, guest satisfaction, and, importantly, provides a strong return on investment. By carefully working within budgets, we deliver high-quality, cost-effective solutions that maximize both aesthetic appeal and financial performance, whether for boutique hotels or expansive resorts.

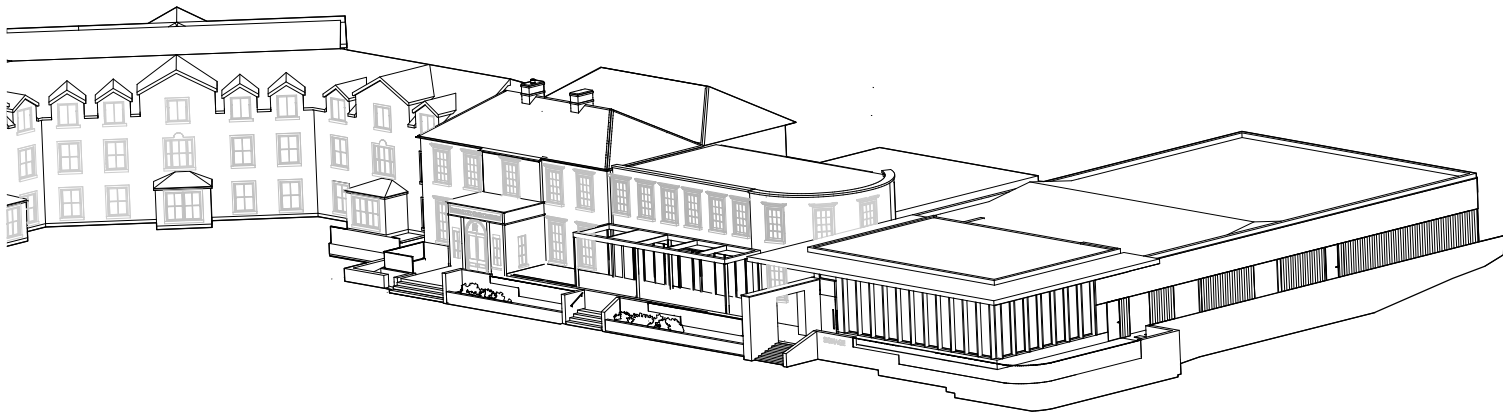

BUNRATTY CASTLE HOTEL

COMING
SOON...

Co. Clare

The hotel underwent a full redesign of its 800sqm public areas, including a striking bar with a 6.5m high ceiling. The interiors featured carefully procured finishes and furnishings, while the commercial kitchen was fully detailed and installed to support hotel operations and events.

Our architects worked with local planning and conservation requirements to design a new 250sqm pre-function room extension, overlooking Bunratty Castle. Outside, granite stone and timber cladding blend seamlessly with polished concrete, paving, and black railings.

- SERVICES**
- Architectural Design & Detailing
 - Interior Design & Detailing
 - Procurement & Scheduling of Finishes & Furnishings
 - Planning Applications & Feasibility Studies
 - Design Certifier

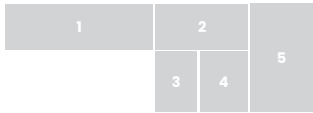

- 1 Axonometric
- 2 Function Room Extension
- 3 Bar Feature Canopy
- 4 Gated Threshold Between Existing and New
- 5 Bar Furniture Detail





IVEAGH GARDEN HOTEL

Dublin 2

The refurbishment of a former bank building on Harcourt Street, transformed it into a 4-star, 150-bedroom sustainable hotel with two additional floors. A full design and fit out transformed the interior with the hotel offering four bedroom types, three bars, and a bistro, providing both travellers and locals with a unique blend of classic and contemporary design.

Our designers worked closely with the client and contractors to ensure smooth procurement and installation of all finishes and furnishings. Our design respects the building's Georgian heritage while incorporating modern elements such as contemporary art-deco style furniture, and a mix of brass, acrylic, timber, marble, and vibrant stone textures.

SERVICES

- Interior Design & Detailing
- Procurement & Scheduling of Finishes & Furnishings
- Assigned Certifier

1	2	3	4
			5

- Bookcase Details
- Bar Counter Detailing
- Bedroom Suite
- Reception Desk
- Concept Sketching



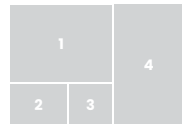

- 1 Reception Lounge
- 2 Bedroom Suite
- 3 Bedroom Suite
- 4 Lounge Area

SHEEN FALLS LODGE /

Co. Kerry

Set amidst 300 acres of breathtaking landscape in County Kerry, the five-star Sheen Falls Lodge is a beautifully restored luxurious retreat offering accommodation with 65 rooms. Along with the elegant suites and private cottages, the hotel redesign also boasted a renowned restaurant and spa.

All finishes and furniture was greatly considered, with close guidance from the client. Monitoring the procurement of these, our designers took on the project management role and worked hard to ensure the hotel's interiors, while decorated in soft, natural hues, were complemented by classic furnishings and modern amenities, creating a refined yet welcoming atmosphere.

SERVICES

- Interior Design & Detailing
- Procurement & Scheduling of Finishes & Furnishings
- Project Management

SANDYMOUNT HOTEL

Dublin 4

The Sandymount Hotel blends historical charm with modern functionality. The facade will be transformed with the installation of a contemporary glazed passenger lift, improving accessibility and enhancing the flow of the space, while making a bold visual statement in the classic Victorian setting. The 150-room hotel combines contemporary style with traditional elements, featuring a fully-equipped restaurant and versatile meeting spaces. Our design team ensured a smooth interior fit-out, while meeting Fire & DAC specifications and managing the project meticulously.

SERVICES

- Architectural Design & Detailing
- Interior Design & Detailing
- Planning Application
- Procurement & Scheduling of Finishes & Furnishings
- Design Certifier
- Fire & DAC Certification
- Assigned Certifier

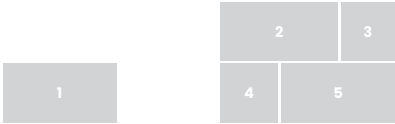

- 1 Axonometric
- 2 CGI of New Passenger Lift Design
- 3 Bar Seating
- 4 Front Entrance Lighting
- 5 Bar Details





CASTLEMARTYR RESORT /

Co. Cork

This five-star resort combines luxury and sophistication with a meticulous design approach. The recent renovation includes new finishes and bespoke furniture throughout, creating an atmosphere of refined elegance. Every space, from the lobby to the guest rooms, was designed for comfort while respecting the building's conservation, particularly in planning and documentation.

A highlight of the redesign is the two Michelin-star restaurant, Terre, where contemporary aesthetics blend with existing mouldings. The interior design creates an immersive dining experience, guided by the client and chef. Public areas feature custom-designed furniture, high-quality finishes, and thoughtful use of light and space, reflecting the resort's commitment to luxury.

SERVICES

- Interior Design & Detailing
- Planning Application
- Procurement & Scheduling of Finishes & Furnishings
- Design Certifier

1

1 Terre Restaurant Dining Room

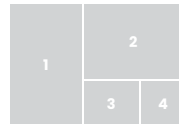

- 1 Front Entrance
- 2 Reception Lounge
- 3 Reception Lounge
- 4 Bedroom Suite

TRINITY TOWNHOUSE /

Dublin 4

The Georgian townhouse that houses the Trinity Townhouse Hotel exudes timeless elegance and historic charm. Limited to the planning and conservation requirements of the property, our design team took direct inspiration from the building's original architecture, carefully conserving its Georgian features. On the interior, classic furniture is paired with opulent furnishings and draperies, creating a harmonious blend of traditional style and contemporary luxury. A neutral palette complemented by antique brass accents seen throughout the interior detailing further enhances the historic ambiance, paying homage to the building's rich heritage.

The project involved the refurbishment of 25 guest rooms, each meticulously designed to offer a refined and comfortable experience, with modern amenities, bespoke furniture, and rich textiles.

Further conservation efforts were focused on preserving the integrity of the Georgian architecture on the exterior, ensuring that key features, such as the original sash windows, decorative plasterwork, and period moldings, were thoughtfully restored and maintained.

SERVICES

- Interior Design & Detailing
- Planning Application
- Architectural Conservation Services
- Procurement & Scheduling of Finishes & Furnishings
- Design Certifier

TULFARRIS MANOR HOUSE /

Co. Wicklow

The interior renovation of Tulfarris Manor House Hotel seamlessly blends historic charm with modern luxury, elevating the guest experience while respecting the building’s heritage. Our design team worked with the client on feasibility studies with the hopes of adding hotel amenities to better the guest experience. On the interior, the manor’s original architectural features were restored to remain part of the design scheme, including graceful chandeliers, intricate mouldings, and grand fireplaces throughout the lobby, lounge rooms, dining rooms and suites of the Manor House.

The design of the 7 exclusive suites was a key focus of the renovation, each one beautifully designed with its own unique scheme. From bespoke furnishings to luxurious textiles, every detail was carefully selected to create an inviting and refined atmosphere. The public spaces, including the lobby, dining areas, and lounges, were also thoughtfully redesigned, receiving new finishes and furnishings, to maintain the building’s historic elegance while offering modern amenities and functionality.

- SERVICES
- Architectural Services
 - Interior Design & Detailing
 - Procurement & Scheduling of Finishes & Furnishings



1	4
2	
3	

- Exterior Night Shot
- Games Room
- Entrance Foyer
- Front Lounge

TULFARRIS RESORT HOTEL /

Co. Wicklow

The complete renovation of Tulfarris Resort Hotel transformed the guest experience, starting with a new front entrance extension, developed in collaboration with local council planning. The interior redesign's key feature is a grand staircase in the reception area, creating a double-height space. The brasserie bar was fully fitted with modern furnishings and high-end finishes, while the first-floor restaurant was expanded. All 86 bedrooms were upgraded, blending modern comfort with stylish design. Our team worked closely with the client, contractors, and consultants to ensure seamless project management throughout the refurbishment.

SERVICES

- Architectural Design & Detailing
- Interior Design & Detailing
- Procurement & Scheduling of Finishes & Furnishings
- Planning Application

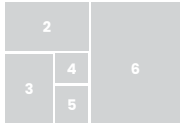
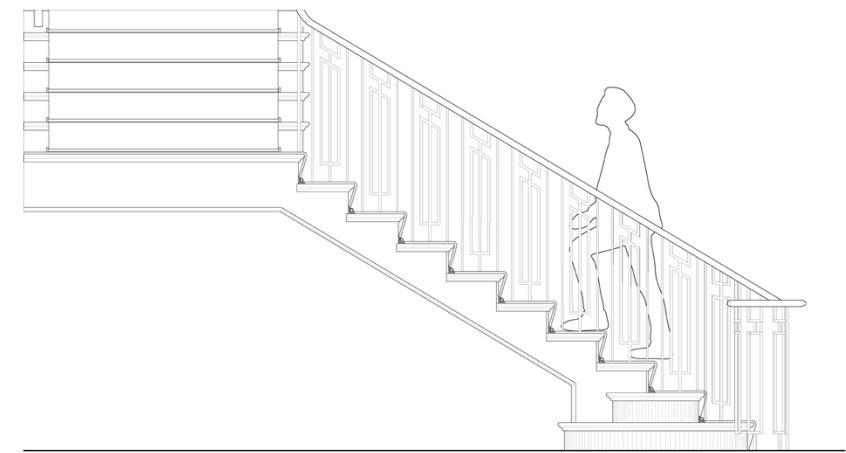

- 1 Stairs Detail Drawing
- 2 Deluxe Bedroom Suite
- 3 Entrance Foyer
- 4 Reception Lounge
- 5 Reception Stair
- 6 Lounge Joinery Details





RADISSON BLU

COMING
SOON...

Dublin 8

Our interior team, in collaboration with the client and contractor, designed a new bedroom scheme for this 234-room hotel that blends contemporary elegance with functional sophistication. Thoughtfully integrated textural elements add depth and interest, while slim, contemporary panelling offers a clean, refined look. A standout feature is the bespoke wardrobe system, designed to maximize space and ensure a clutter-free environment with hidden compartments and intuitive organisation.

SERVICES

- Interior Design & Detailing
- Procurement & Scheduling of Finishes & Furnishings
- 3D Visualisation Services



- 1 CGI Visual Suite Headboard
- 2 CGI Visual Desk
- 3 CGI Visual Wardrobe

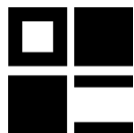

BARS & RESTAURANTS /

When designing bars and restaurants, Studio Duffy always aim to create unforgettable experiences. Our approach blends innovative design with a deep understanding of hospitality – crafting spaces that are both visually striking and functionally efficient.

From intimate dining rooms to vibrant bars, cozy cafés to upscale restaurants, we work closely with owners to ensure that every design element enhances the atmosphere, drives foot traffic, and supports seamless operations. We create spaces that engage the senses and invite guests to linger longer.

GALLERY BAR, LE POLE SQUARE

COMING
SOON...

Dublin 8

Located in the historic Le Pole Square, a conservation site preserving Dublin's Viking heritage, this vibrant wine bar and event space blends contemporary industrial design with historical significance.

The interior features a striking metal bar canopy and bold red accents, creating an energizing yet inviting atmosphere. High-end finishes and modern furnishings add comfort and sophistication. A graphic historical timeline highlights Dublin's Viking roots, seamlessly integrating the region's history into the design.

Designed as both a wine bar and flexible event space, the venue accommodates everything from intimate tastings to larger gatherings.

SERVICES

- Interior Design & Detailing
- 3D Visualisation Services
- Procurement & Scheduling of Finishes & Furnishings



1 CGI Visual of Gallery Wine Bar





ALLTA RESTAURANT /

Dublin 2

Located in a protected Georgian-front townhouse in Dublin, Allta Restaurant blended refinement with a laid-back atmosphere. Though now under new ownership, the architectural team carefully preserved the building's historic value with conservation efforts.

The interior design balanced sophistication and relaxation, with a large graphic focal point sparking conversation. Rustic woods and metals created a warm, inviting atmosphere, while bespoke furnishings and innovative lighting encouraged guests to unwind and enjoy exceptional cuisine.

SERVICES

- Interior Design & Detailing
- Procurement & Scheduling of Finishes & Furnishings
- Planning Application
- Design Certifier



1 Feature Graphic to Dining Space



2 GA Plan of Dining Area

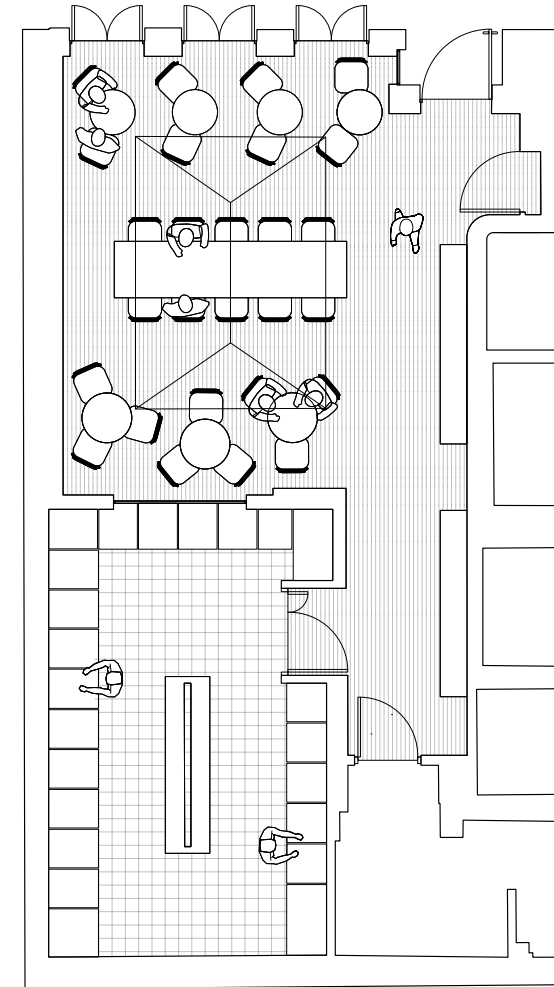



BAR ITALIA RISTORANTE

MORE TO
COME...

Dublin 1

The dining room of Bar Italia undertook a full interior refurbishment which our team worked diligently throughout the project management to ensure smooth delivery and to guarantee all interior detailing, scheduling and furnishings were correctly installed. While the architectural team worked closely with the city council's requirements for planning and retention of some areas for the restaurant.

On the interior, elegant ebony staining provides a rich backdrop for displays. Carefully chosen touches of blues and tans bring depth and vibrancy. Accents of brass metal add a hint of sophistication, creating a harmonious blend of textures and colours.

SERVICES

- Interior Design & Detailing
- Procurement & Scheduling of Finishes & Furnishings
- Planning Application
- Project Management
- Design Certifier

1	2	3	4
---	---	---	---

- 1 Dining
- 2 Furniture Detail
- 3 Bar Detail
- 4 Brass and Glass Screening

TERENURE INN

Dublin 6

The redesign of Terenure Inn Pub’s lounge creates a fresh, welcoming atmosphere with a feminine touch, featuring soft floral fabrics, delicate accents, and a harmonious colour palette. Bespoke lampshades provide a soft, ambient glow, enhancing the space’s charm.

The outdoor terrace was transformed with a new metal-structured, glazed roof, blending modern finishes, greenery, and bespoke neon signage, creating a year-round indoor/ outdoor space.

Close collaboration between our interiors and architecture teams, along with the client and contractors, ensured a seamless delivery of the project.

- SERVICES
- Architectural Design & Detailing
 - Interior Design & Detailing
 - Procurement & Scheduling of Finishes & Furnishings
 - Planning Application
 - Project Management

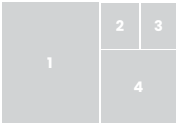

- 1 Cocktail Lounge
- 2 Lighting and Panelling Detail
- 3 Outdoor Terrace Seating
- 4 Bespoke Neon Signage

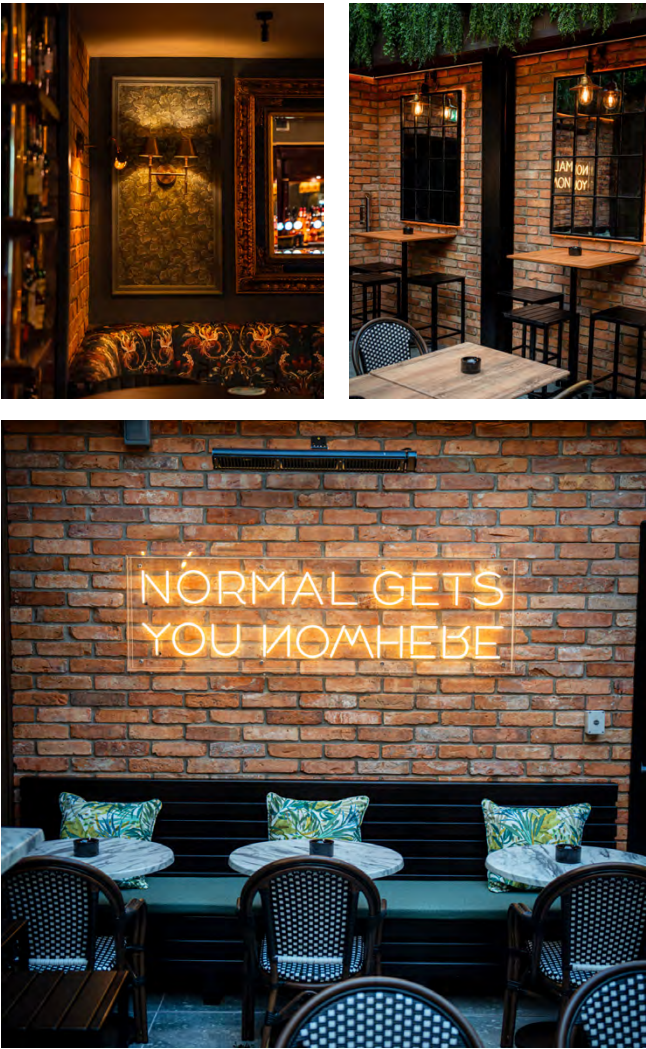

THE BRACKEN / GRILL

Co. Dublin

The complete redesign of the Bracken Court Hotel's restaurant and bar draws inspiration from Balbriggan's weaving heritage and coastal location, with the plan revised to better align with both the client's and hotel's needs.

The restaurant features a warm, rusty colour scheme and textured materials like natural woods and woven fabrics, reflecting the town's craftsmanship. Bespoke joinery adds refinement. In contrast, the bar adopts calming blues, evoking the seaside, with elegant joinery and ambient lighting to create a relaxed atmosphere.

Carefully considered lighting enhances both spaces, ensuring each offers a unique experience while maintaining a cohesive design.

SERVICES

- Interior Design & Detailing
- Procurement & Scheduling of Finishes & Furnishings



1

1 Bracken Grill Restaurant



+353 1 284 4455
info@studioduffy.ie
24 The Crescent, Monkstown
studioduffy.ie